

SPEC SHEET L95 – LID SNAP ON

PRODUCT DIMENSIONS

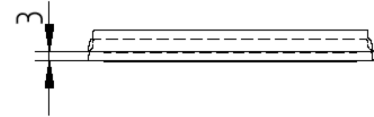

| | |
|--------------|--|
| CLOSURE TYPE | Snap on |
| WEIGHT | 4.0 g |
| SHAPE | Round |
| TUB OPTIONS | 180T, 240T, 280T, 365T, 520T |
| DECORATION | In-Mould-Labeling (IML) options are available in various film substrates |
| MATERIAL | <p>Polypropylene</p> <p>This product meets the purity limits as stated in AS2070-1999, which relates to plastic materials suitable for food contact applications.</p> |
| COLOURS | Natural, Clear, White, Black, Customer specific colours on request |
| APPLICATION | <ul style="list-style-type: none"> • Room Temperature / Fridge: standard material • Freezer: special material required • Hot Filling: special material required <p>In all cases, customer should conduct its own trials to ensure the suitability of this packaging for its chosen application</p> |
| FEATURES | Re-heating (may be microwaved), leak resistant, tamper evident |
| PACKAGING | <p>QTY per carton: 1,500</p> <p>Carton size: 510 X 310 x 340 mm</p> <p>Carton liner: HDPE blue plastic liner bag</p> <p>Full carton weight: 7 kg</p> <p>Pallet size: 1165 x 1165 x 2180 mm (max 48 boxes per pallet)</p> |

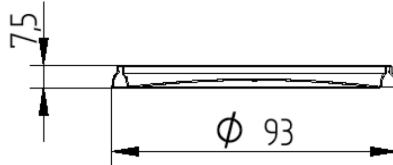
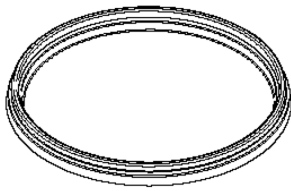